

MICRO SWITCHES



Single-pole change-over snap-action Switches featuring exceptional repeat accuracy with beryllium copper, trident spring mechanism & silver contacts. Precision design and superior material ensures satisfactory service in a wide variety of applications in domestic, office, lab. or workshop equipments, especially when small controlled movements and accurate repeat performance are essential requirements.

Basic Switches are available in three types, i.e; 'Fin' type, 'T' type and 'Side Screw' type

Auxiliary Actuators to suit individual applications can be supplied with any basic switch

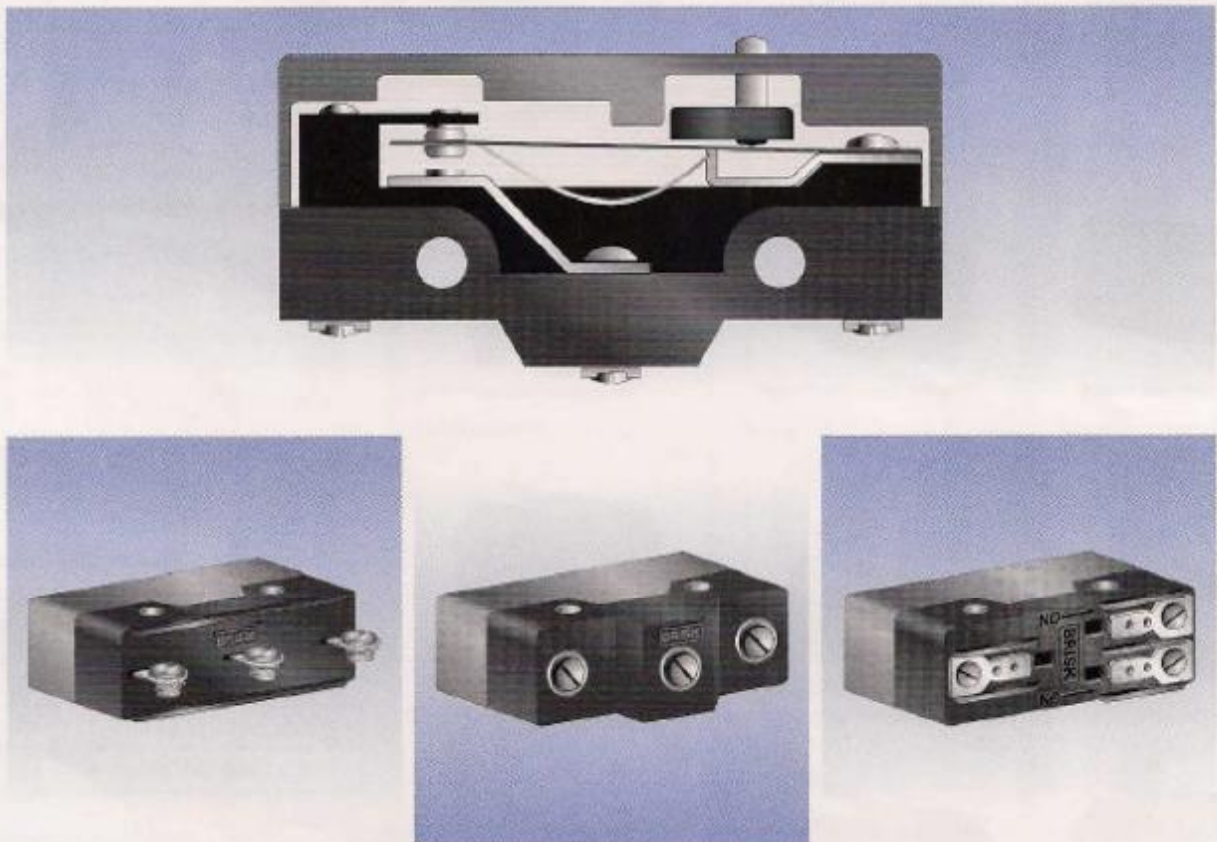

Specification : Conforms to ISS 6089 & JSS 51204.

Material :-

Housing & Cover	: Superior electrical grade phenolic material.
Contacts	: Silver Cadmium Oxide.
Spring	: Beryllium Copper.
Terminals	: Brass
Rating	: 5A / 250 V AC, 15A / 250 V AC
Contact Resistance	: 10 m Ohms (Max.)
Temperature	: -10 deg.C to + 85 deg.C

Mech. life	: 10 million operations
Insulation resistance	: 100 m Ohms min.
Actuating Force	: 500 gms (Max)
Release Force	: 100 gms (Min)
Movement diff.	: 0.08mm (Max)
Over Travel	: 0.20 mm
High Voltage Test	: 1 KV AC between open contacts



Short Plain Lever
B3_01



Basic Micro Switch
B3_00



Medium Plain Lever
B3_02

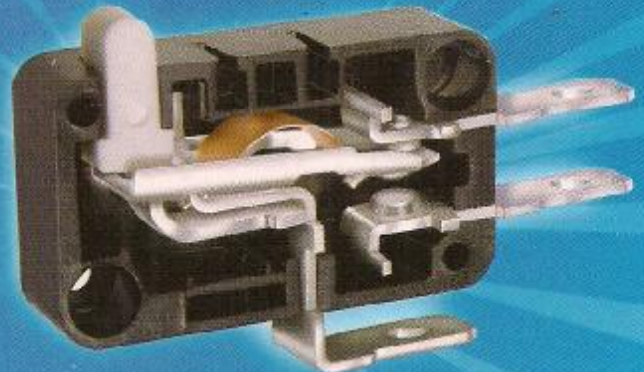

Extended Plain Lever
B3_03



Short Roller Lever
B3_05



Medium Roller Lever
B3_06



Medium Lever with V Notch
B3_07



Simulated Lever
B3_08

B 3 Miniature Micro Switches

TERMINALS



Screw type
A



Soldier type
B



Push On (QC)
C



Brisk Miniature Micro switch is widely used for operating in
Refrigerator, Pressure Switch, Electro Mechanical Timer, Washing Machine, Electric Rice Cooker, Over Head Projector,
Vending Machine, Food Processor, Electronic Voting Machine, Microwave Oven, Servo Stabilizer, Elevator, Mixer Grinder,
Floor Cleaning Machine, Centre Lock in Automobiles, Trivector Meter, Bag Sealing Machine, Door Opening Closing,
On Line Starter, Telephones etc.

• QUALITY • SERVICE • RELIABILITY • DESIGN FLEXIBILITY • LATEST TECHNOLOGY

BASIC SWITCH WITH AUXILIARY ACTUATORS



Plain Leaf B3_09



Roller Leaf B3_10



Hinged Lever B3_11



Hinged Lever with Roller B3_12



Extended Hinged Lever
B3_13



Extended Hinged Lever
with Roller B3_14



Finger Push Button (S.P.) B3_15



Finger Push Button (D.P.) B3_16



Push Button (S.P.) B3_17



Push Button with (D.P.) B3_18



Auxiliary Panel
Mount Roller Plunger
S.P. / D.P.
B3_19 / B3_20



Auxiliary Panel
Mount Plunger
D.P. / S.P.
B3_22 / B3_21



Door
Interlock
Switch
B3_23

TECHNICAL DATA ELECTRICAL RATING

Colour of Plunger	Operating Force Max.	Release Force Min.	Rating
Black	500 gms	175 gms	10A/250VAC
White	400 gms	125 gms	10A/250VAC
Yellow	200 gms	75 gms	5A/250 VAC
Blue	100 gms	40 gms	3A/250 VAC
Red	50 gms	20 gms	2A/250 VAC

CURRENT RATING

Voltage	Resistance Load AMPS.	Inductive Load AMPS.
125 V AC	10	10
230 V AC	10	5
440 V AC	5	2
50 V DC	8	On Application
125 V DC	0.5	On Application
230 V DC	0.25	On Application

DIMENSIONS

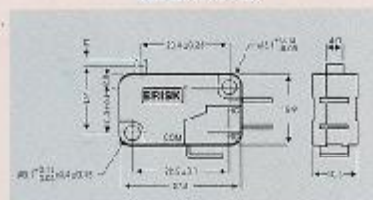

ELECTRICAL

- High Voltage : 2000V AC between each terminal and ground.
1000 V AC between open contacts
- Contact Resistance : 20 milliohms max. (initial)
- Insulation Resistance : 100 Mohms min. at 500 VDC
- Electrical Life : 1,00,000 operations at rated resistance current.
- Temperature Range : Operational range is -40°C to +85°C

MATERIAL:

- Body : Glass filled Thermoplastic
- Plunger : Nylon
- Contact : Silver Alloy
- Contact Blade : Phosphorus Bronze
- Working Spring : Beryllium Copper
- Terminals : Brass Silver Plated
- Screws : Brass Nickel Plated

• SPECIFICATION: Switches Comply with IEC 60947-5-1.

• APPROVALS : CE

• Tested at: ERTL, Mumbai.

Manufactured By:



BRISK INDUSTRIES

Micro Switches, Foot Switches, Limit Switches,

At Post : Kandali, Dist.: Pune 412 412, Maharashtra, India.

Mobile : 9833714805 / 9833872107



E-mail : briskbk@yahoo.com / info@brisk.co.in

Oil Tight Limit Switches

BEST Series

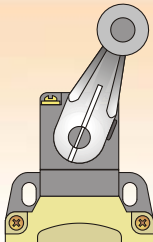
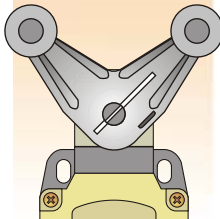
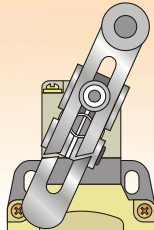
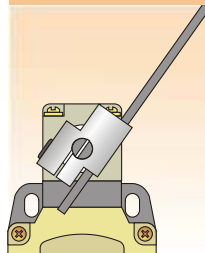
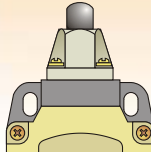
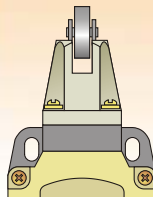
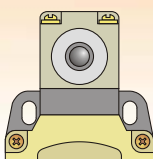
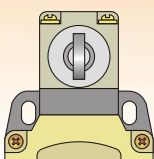
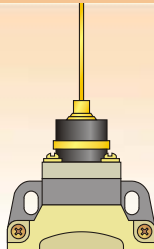

ACTUATORS

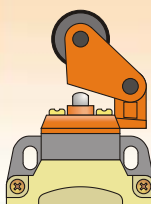
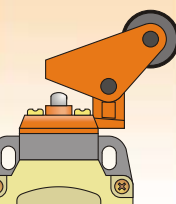
Roller Lever R 38/50/64/76  BEST 01-04	Yoke Roller Lever  BEST 05	Adjustable Roller Lever  BEST 06	Adjustable Rod Lever  BEST 07	Top Plunger  BEST 08	Top Roller Plunger  BEST 09
Side Plunger  BEST 10	Side Roller Plunger  BEST 11	Wobble Lever  BEST 12	Push Pin  BEST 13 N/S	Side Roller Lever  BEST 14 N/S	Angular Roller Lever  BEST 15 N/S

GENERAL DATA

Housing Material	: Aluminium Die Casting	Switching Principle	: Snap-Action/Normal Action
Mounting Pitch	: 40 mm	Freq. of Operation	: 2500 Operation/Hour
High Temp.	: 90° C (Max.)	Terminal Capacity	: 2.5 mm 2 Solid or Stranded
Low Temp.	: -40° C (Min.)	Plunger Guide	: Maintenance Free
Mechanical Life	: Over 10 million cycles	Circuitry	: 2 Circuit double break
Electrical Life	: Over 500 thousand cycles	Enviro. Protection	: IP67
Electrical Rating	: 10 Amps 250 V AC	Weight	: 350 gm

BEST LIMIT SWITCHES

1. Are compact & light weight designed.
2. Are completely oil, watertight, dust & damp proof.
3. Trouble free operation in highly contaminated atmosphere & vibration condition.
4. Are of 15 different actuators with levers & plungers.
5. Robust construction, high quality corrosion resistant.
6. Switching element is Normal action / Snap action with 1NO+1NC

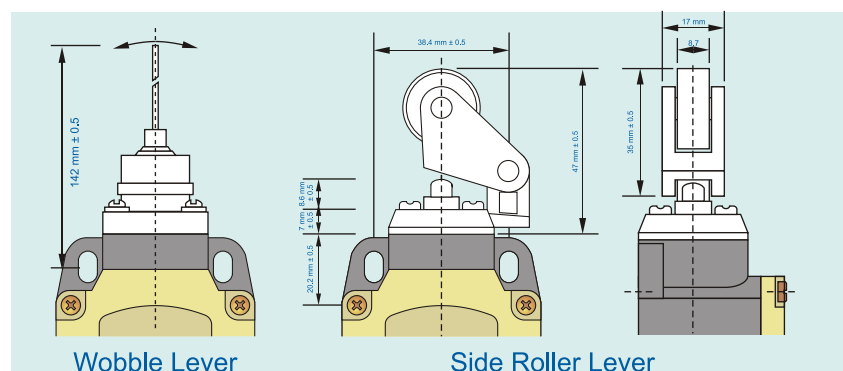
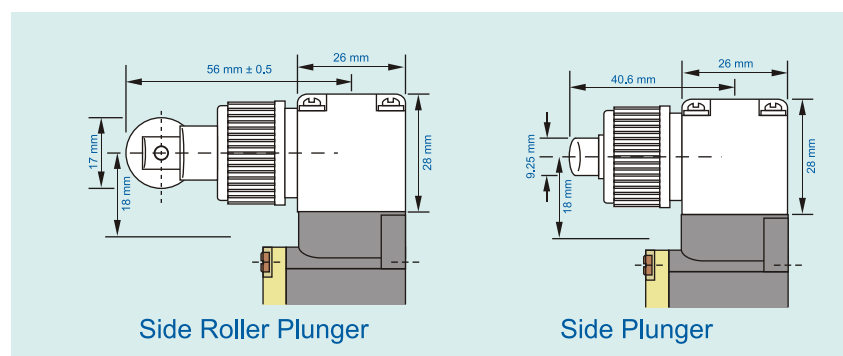
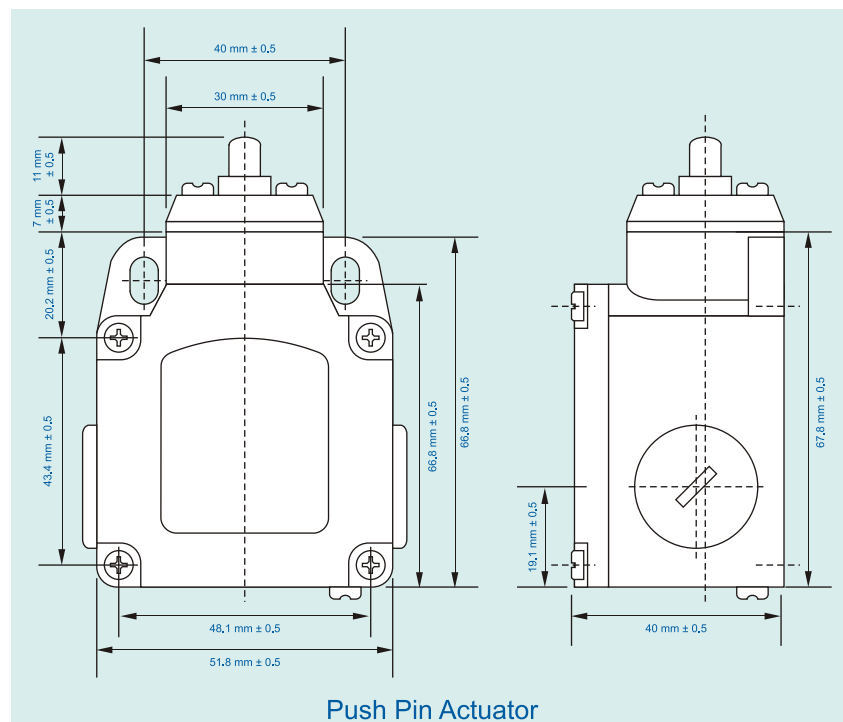

DIMENSIONAL DETAILS

A = Operating Point : B = Final Position :
C = Reset Point

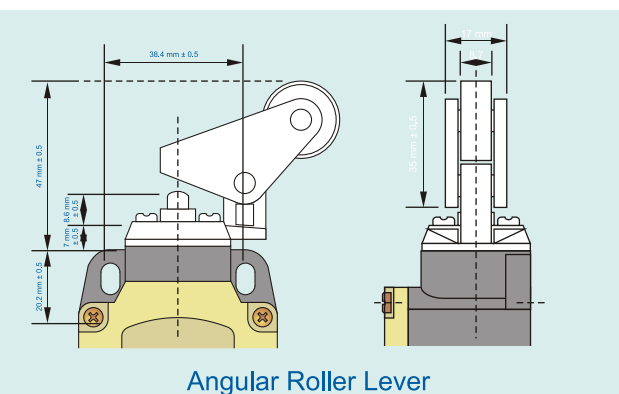
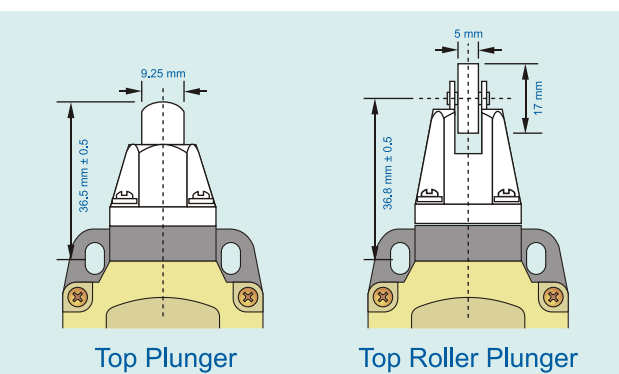
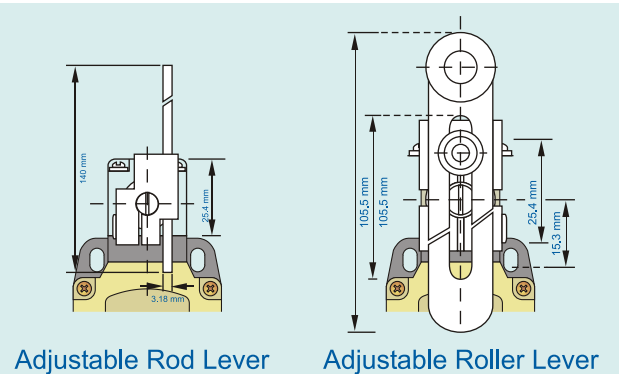
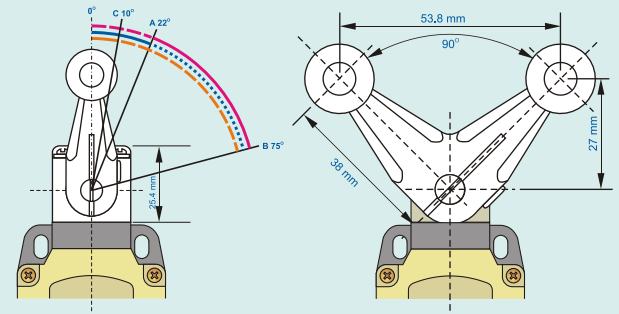

MANUFACTURED BY

BRISK INDUSTRIES

PUNE - INDIA



LSO/LSOS



LSO-ES/LSOS-ES



BML-001/BML-001S



LSO-001/LSOS-001



LSR/LSRS



LSP/LSPS



LSR-O/LSRS-O



LSP-O/LSPS-O

PRECISION LIMIT SWITCH

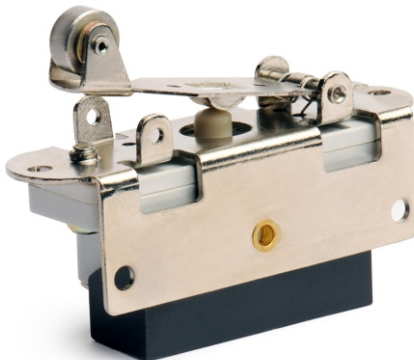

BRISK Precision Limit Switches are designed for industrial applications. These are small in size, reliable in operation, have exceptionally long life and are accurate. The wide variety of switch operating mechanism coupled with the choice of either single pole 1NO + 1 NC or double pole 2 NO + 2 NC changeover contacts permit selection and application for many needs.

Contact Mechanism:

The contact mechanism incorporates a movable assembly utilizing two compressed spring to provide quick-make, quick-break action which eliminates any position of zero contact pressure and ensures no-testing action, even with an extremely slow operating motion.

The light weight beryllium-copper carrier with large faced silver contacts and low bounce mechanism assure long life on high load applications. The silver contacts, definite wiping action and high contact pressure assure reliability on dry circuit applications. The switch is completely enclosed in a semi dust-tight moulded, phenolic case of great physical strength and high arc-resisting capacity.

Versatile: A wide variety of operators are available for use in combination with the basic switch. These operators with individual mounting variations afford a high degree of versatility.

Types of Operators

Push button plunger:

These are designed for one hole panel mounting. The plunger mechanism is of oil-tight construction. These operators are designed for an in-line actuating motion with controlled over-travel.

Top push roller plunger:

Operators are designed for one hole mounting and are of oil-tight construction. The roller plunger comes assembled either in line with the length of the contact block or right angles to it. This allows the roller to accept cam or slide operations from any of the four directions.

Six inch (150 mm) lever:

These operators provide either top and right hand mounting or top and left hand mounting. With this do-it yourself operator, the lever may be formed by the user to satisfy unusual requirement and can be cut or bent to any desired length or shape.

Roller lever:

These operators are available with either top and right hand mounting or top left hand mounting and are equipped with a steel roller which may be operated by a cam or some similar actuating device. Operation is provided in both directions.

Technical Details

PRECISION LIMIT SWITCH

Electrical & Mechanical Ratings

Thermal Current (Ith) : 15 A

Insulation Voltage (Ui) : 600 V AC.

Operational Current and Voltage :

AC rating	Single Pole (1No+1Nc changeover contacts)	Double Pole (2No+2Nc changeover contacts)
110V	4.0 A	3.0 A
240V	2.0 A	1.5 A
440V	1.0 A	0.8 A
600V	0.8 A	0.6 A

DC rating	Single throw	Double throw	Single throw	Double throw
115V	2.0A	0.50A	1.0A	0.2A
230V	0.5A	0.20A	0.3A	0.1A
600V	0.1A	0.02A	0.1A	-

Contact Combination :

- a) Single Pole 1NO+1NC changeover contacts
- b) double Pole 2NO+2NC changeover contacts

Frequency of operation :

2500 operation per hour (max)

Mechanical and electrical life :

20x10⁶ operation without operator

10x10⁶ operation without operator

Terminal capacity :

2.5 mm solid or standard conductors

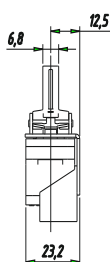
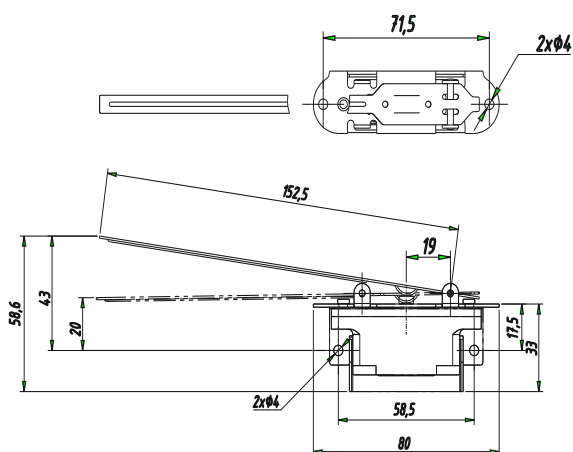
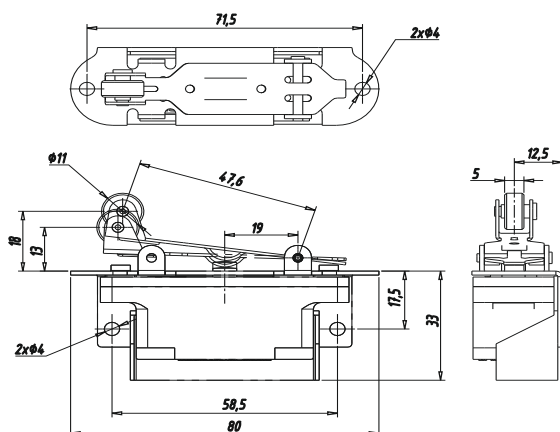
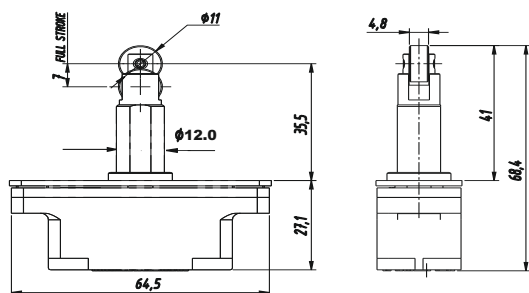
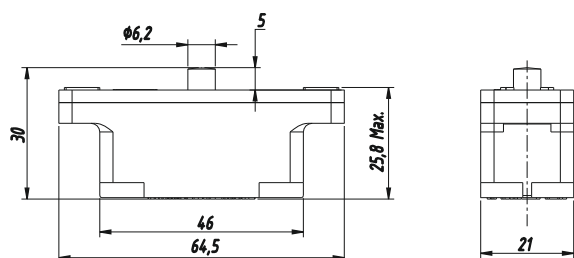

BRISK

 <p>BRISK 10A 250VAC BZ-7100</p>	BZ-7100	 <p>BRISK 10A 250VAC BZ-7110</p>	BZ-7110
 <p>BRISK 10A 250VAC BZ-7121</p>	BZ-7121	 <p>BRISK 10A 250VAC BZ-7141</p>	BZ-7141
 <p>BRISK 10A 250VAC BZ-7124</p>	BZ-7124	 <p>BRISK 10A 250VAC BZ-7144</p>	BZ-7144
 <p>BRISK 10A 250VAC BZ-7166</p>	BZ-7166	 <p>BRISK 10A 250VAC BZ-7310</p>	BZ-7310
 <p>BRISK 10A 250VAC BZ-7311</p>	BZ-7311	 <p>BRISK 10A 250VAC BZ-7312</p>	BZ-7312

MICRO MINIATURE LIMIT SWITCHES



FOOT OPERATING SOLUTIONS



Foot switches are widely used for operating various machines like Power-presses, Drill Machines, Packaging machines, Spot & Tig welders, Conveyors, Electro & Biomedical Equipments and also used in circuits of machines like Textile, Medicine and Automatic Production line.

• QUALITY • SERVICE • RELIABILITY • DESIGN FLEXIBILITY • LATEST TECHNOLOGY



BFS-01

10A-250 Volt AC. ; (Push to ON Release to Off)
Contacts : 1NO + 1NC
Body : Aluminum Pressure Die-Casting
Weight : 160 Gms. Approx.

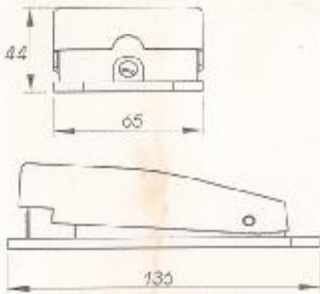
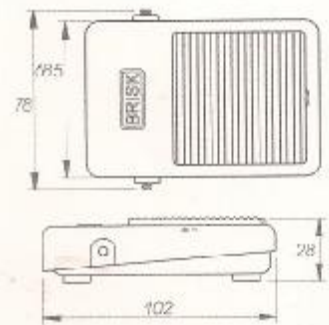

BFS-02

10A-250 Volt AC. ; (Push to ON Release to Off)
Contacts : 1NO + 1NC
 10A-250 Volt AC. ; (Push to ON Push to Off)
Contacts : 1NO
Body : Aluminum Pressure Die-Casting
Weight : 250 Gms. Approx.



BFS-03

10A-250 Volt AC. ; (Push to ON Release to Off)
Contacts : 1NO + 1NC
 10A-250 Volt AC. ; (Push to ON Push to Off)
Contacts : 1NO
Body : Aluminum Pressure Die-Casting
Weight : 400 Gms. Approx.

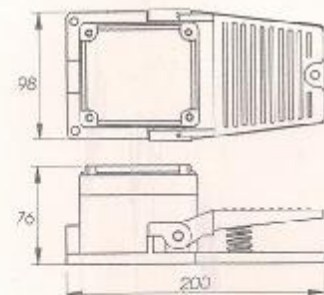
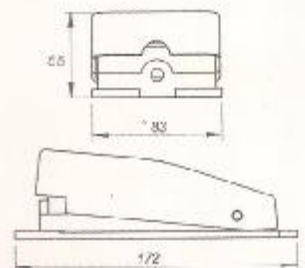

BFS-04

10A-250 Volt AC. ; (Push to ON Release to Off)
 10A-500 Volt AC. ; (Push to ON Release to Off)
Contacts : 1NO + 1NC
 10A-500 Volt AC. ; (Push to ON Release to Off)
Contacts : 2NO+2NC
 10A-250 Volt AC. ; (Push to ON Push to Off)
Contacts : 1NO
Body : Aluminum Pressure Die-Casting
Weight : 750 Gms. Approx.



BFS-05

10A-250 Volt AC. ; (Push to ON Release to Off)
 10A-500 Volt AC. ; (Push to ON Release to Off)
Contacts : 1NO + 1NC
 10A-500 Volt AC. ; (Push to ON Release to Off)
Contacts : 2NO+2NC
 10A-250 Volt AC. ; (Push to ON Push to Off)
Contacts : 1NO
Body : Aluminum Pressure Die-Casting
Weight : 900 Gms. Approx.

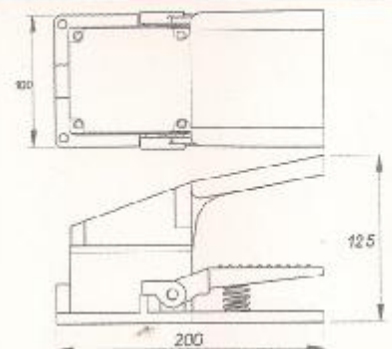

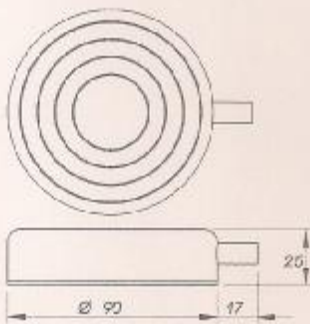

BFS-06

Capsule
6A-250 Volt AC. ; (Push to ON Release to Off)
Contacts : 1NO
Body : Rubber
Weight : 250 Gms. Approx.



BFS-07

Trigger
10A-250 Volt AC.
Contacts : 1NO + 1NC
Body : Aluminum Pressure Die-Casting
Weight : 350 Gms. Approx.

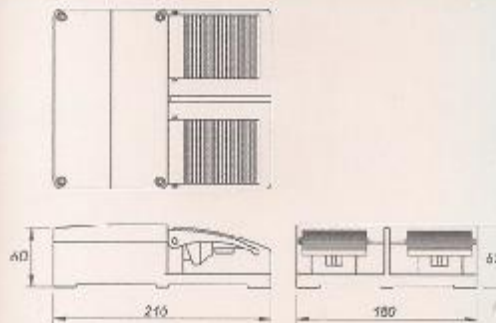
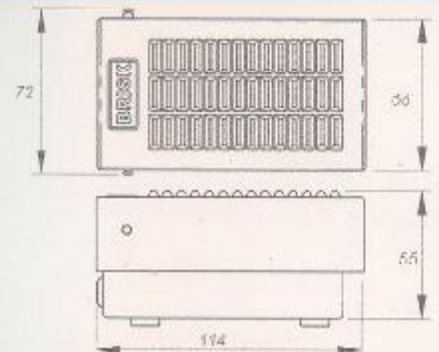

BFS-08

Twin Foot Switch
10A-250 Volt AC.
Contacts : 1NO + 1NC
Body : Aluminum Casting
Weight : 1540 Gms. Approx.

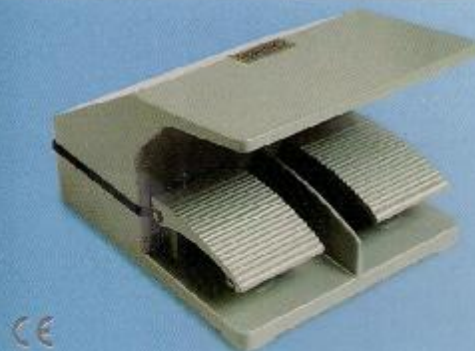

BFS-09

Twin Foot Switch
10A-250 Volt AC.
Contacts : 1NO + 1NC
Body : Aluminum Casting
Weight : 2300 Gms. Approx.

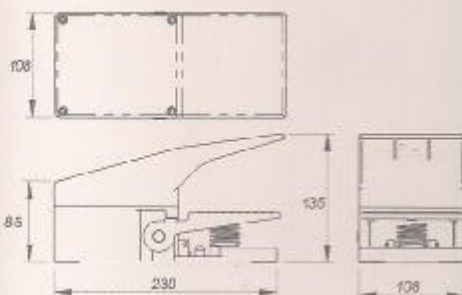
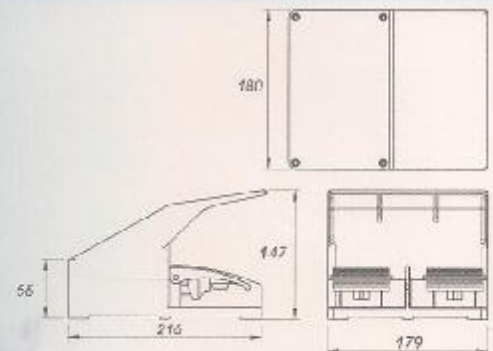

BFS-10

Heavy-Duty
10A-500 Volt AC.
Contacts 1NO+1NC. (S S)
10A-500 Volt AC. **Contacts** 2NO+2NC. (S S)
10A-500 Volt AC. **Contacts** 1NO+1NC. (D S)
10A-500 Volt AC. **Contacts** 2NO+2NC. (D S)
Body : Aluminum Pressure Die-Casting
Weight : 1500 Gms. Approx.





BFS-11

Heavy-Duty

10A-500 Volt AC. Contacts 1NO+1NC. (Single Switch)
 10A-500 Volt AC. Contacts 2NO+2NC. (Single Switch)
 10A-500 Volt AC. Contacts 1NO+1NC. (Double Switch)
 10A-500 Volt AC. Contacts 2NO+2NC. (Double Switch)

Body : Aluminum Pressure Die-Casting

Weight : 1000 Gms. Approx.

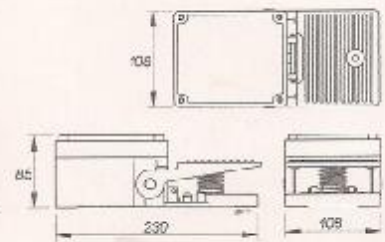

CE

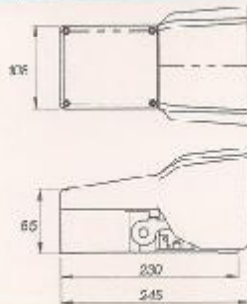

BFS-12

Heavy-Duty

10A-500 Volt AC. Contacts 1NO+1NC. (Single Switch)
 10A-500 Volt AC. Contacts 2NO+2NC. (Single Switch)
 10A-500 Volt AC. Contacts 1NO+1NC. (Double Switch)
 10A-500 Volt AC. Contacts 2NO+2NC. (Double Switch)

Body : Aluminum Pressure Die-Casting

Weight : 1850 Gms. Approx.



CE



BFS-13

Popular

10A-250 Volt AC. ; (Push to ON Release to Off)

Contacts : 1NO + 1NC

10A-250 Volt AC. ; (Push to ON Push to Off)

Contacts : 1NO

Body : Aluminum Pressure Die-Casting

Weight : 300 Gms. Approx.

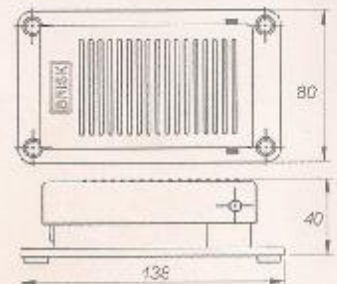

CE

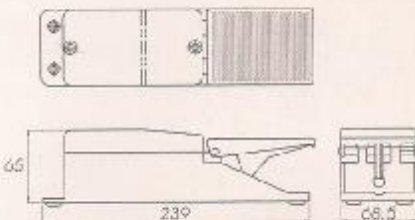

BFS-14

10A-250 Volt AC. ; (Push to ON Release to Off)

Contacts : 1NO + 1NC

10A-250 Volt AC. ; (Push to ON Push to Off)

Contacts : 1NO

AC Variable Speed Control Foot Switch.

6A-125 V AC / 4A-250 V AC

Body : Aluminum Pressure Die-Casting

Weight : 800 Gms. Approx.



CE

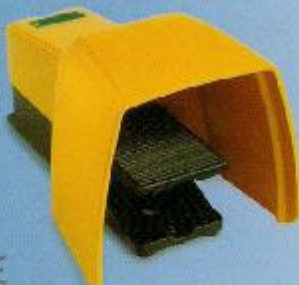

BFS-15

10A-250 Volt AC. ; (Push to ON Release to Off)

Contacts : 1NO + 1NC

10A-250 Volt AC. ; (Push to ON Push to Off)

Contacts : 1NO

AC Variable Speed Control Foot Switch.

6A-125 V AC / 4A-250 V AC

Body : Aluminum Pressure Die-Casting

Weight : 1514 Gms. Approx.

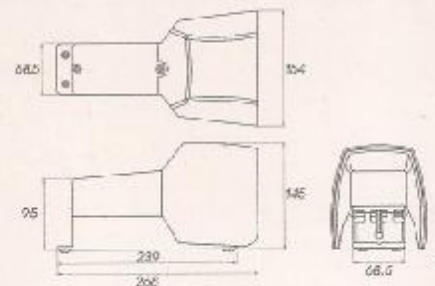

CE

Manufactured By:

BRISK INDUSTRIES

Micro Switches, Foot Switches, Limit Switches,

At Post : Kandali, Dist.: Pune 412 412. Maharashtra, India.

Mobile : 9833714805 / 9833872107

E-mail : briskbk@yahoo.com / info@brisk.co.in